



# THE BELMONT<sup>®</sup>

---

## RAPID INFUSER RI-2

Rapid, reliable, and bubble-free delivery of life-saving warmed blood and fluid at a touch of a button.

---

**SAVING LIVES. TOGETHER.**





MILITARY



OPERATING ROOM



LABOR & DELIVERY AND PEDIATRICS



EMERGENCY & CRITICAL CARE

# "THE BELMONT" BRINGS CONFIDENCE

Used in the most extreme situations for more than 20 years, The Belmont Rapid Infuser has earned the trust of clinicians worldwide. It's a simple, safe, and effective solution for high-speed delivery of warmed fluids. Experience peace of mind, knowing you're prepared for the worst but equipped with the best.

## BUBBLE-FREE. RELIABLE. FAST.

### RAPID INFUSER RI-2

- 1 Vent/Recirculation Line
- 2 Input Air Detector
- 3 High Speed Peristaltic Pump
- 4 Input Temperature Probe
- 5 Heat Exchanger
- 6 Output Temperature Probe
- 7 Touchscreen Display
- 8 Pressure Sensor/Debubbler
- 9 Output Air Detector
- 10 Infuse/Recirculation Valve

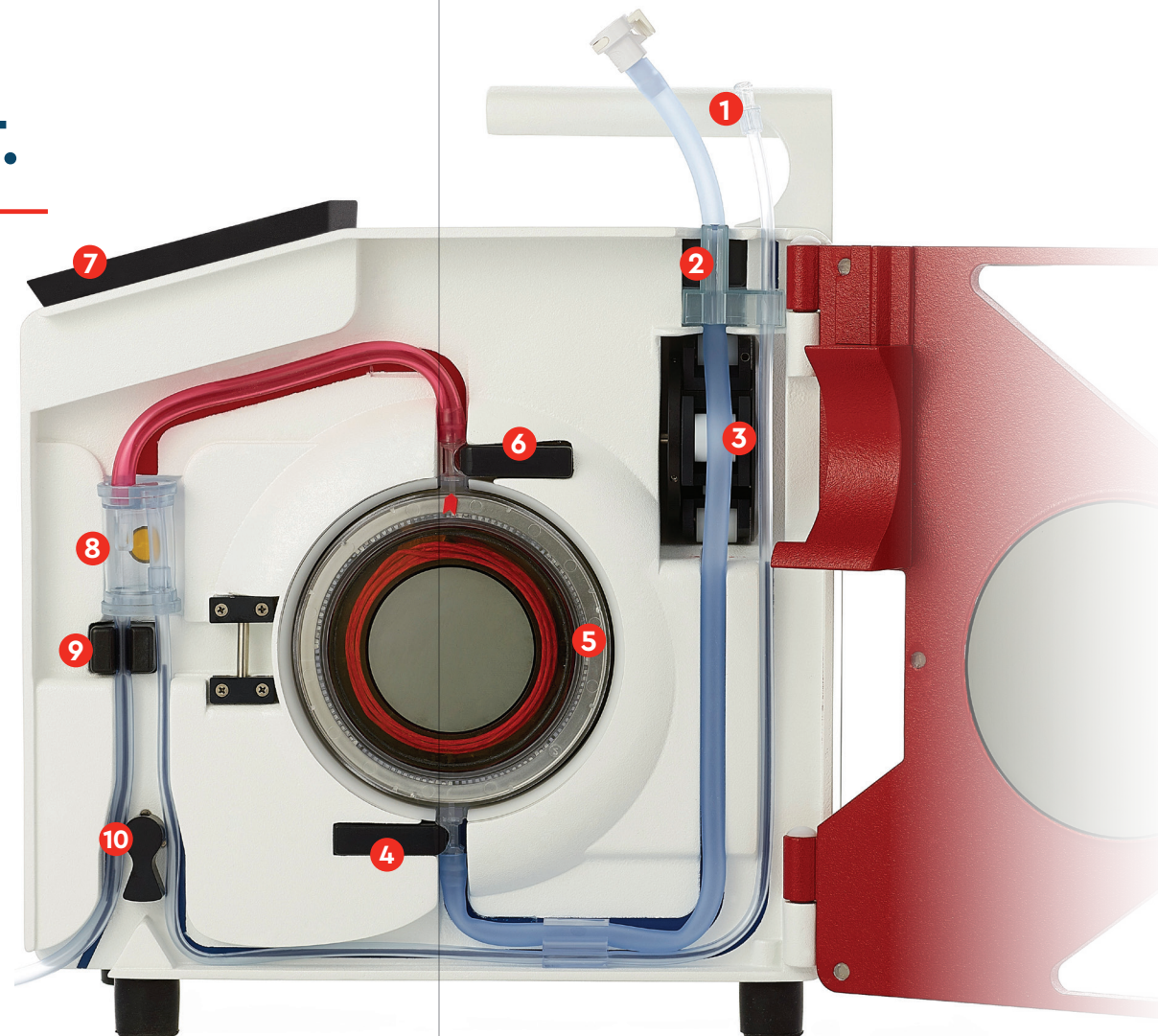

**AUTOMATIC AIR DETECTION & REMOVAL**  
Two ultrasonic air detectors and patient safety valve safeguard against air emboli.

**AUTOMATIC PRIMING**  
Fully prime in under 1 minute and easily re-prime without patient disconnection.

**HIGH SPEED PERISTALTIC PUMP**  
Precise control of fluid delivery with flow rates ranging from 2.5 to 1000 ml/min.

**ELECTROMAGNETIC INDUCTIVE HEATING**  
Dry, inductive heating technology and two infrared temperature sensors provide consistent normothermic fluid within seconds.

**ADVANCED PRESSURE REGULATION**  
Automatic pressure monitoring and flow rate adjustment when pressure exceeds 300 mmHg.

**INTUITIVE TOUCH-SCREEN DISPLAY**  
High contrast display provides easy to follow on-screen instructions, clear descriptions of alarms and alerts, and quick access to device operations.

#### REAL-TIME DISPLAY OF:

- Set Rate
- Actual Rate
- Total Volume Infused
- Line Pressure

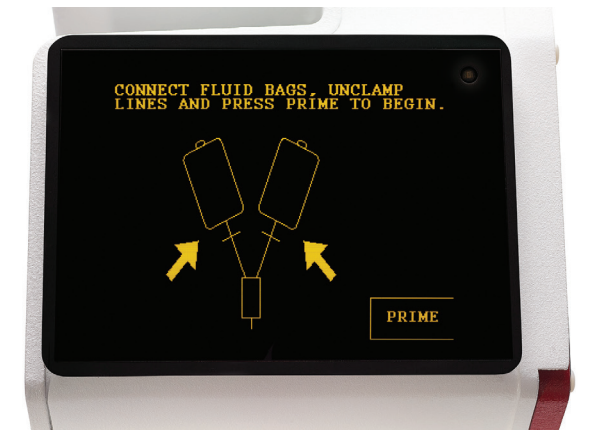
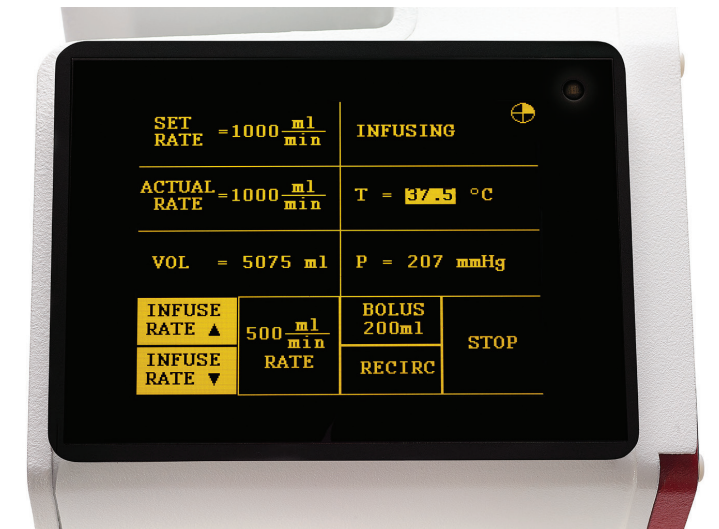

## ORDERING INFORMATION

### RAPID INFUSER RI-2, 1000 ml/min

Infusion rate: 2.5-1000 ml/min

- US: Part #903-00037 (120V)
- International: Part #903-00037A (230V)

### RAPID INFUSER RI-2, 750 ml/min

Infusion rate: 2.5-750 ml/min

- US: Part #903-00039 (120V)
- International: Part #903-00039A (230V)
- NSN: 6515-01-661-8500 (120V)

### 3-SPIKE DISPOSABLE SET

Part #903-00006 (12 sets/case)

Part #903-00106 (6 sets/case)

### 3.0 LITER RESERVOIR (LVR)

Part #903-00018

### 4X4 LVR & HEAT EXCHANGER SET

Part #903-00032

### PATIENT LINE EXTENSION

Part #903-00022

### DUAL PATIENT LINE

Part #903-00004

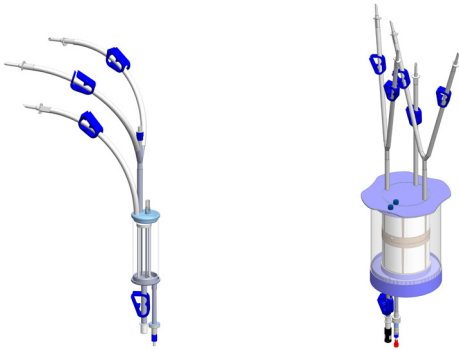

#### STANDARD

120 ml Reservoir (3-Spike)

#### OPTIONAL

3.0 Liter Reservoir (5-Spike)

## HARDWARE SPECIFICATIONS

### DIMENSIONS

13.5 in. x 7.5 in. x 12 in.

342.9 mm. x 190.5 mm. x 304.8 mm.

### WEIGHT

28 lb.

12.7 kg.

### PORTABILITY

Quick-on IV pole mount/handle at top of unit

### POWER

115 volt or 220/240 volt AC input

### BATTERY

Internal, rechargeable for transport

Operates all functions without heating

### FLUID PUMP

Roller type peristaltic pump

Flow rate 2.5-1000 ml/min

### HEATER

Maximum applied power, 1440 watts

### SENSORS

2 air detectors, pressure transducer, 2 temperature probes (infrared sensing), pump infusion rate sensor, open door detector, and valve activation sensors

### CONTROL COMPUTER

Built-in, controls all functions

Redundant hardware override protection in case of computer failure

### DISPLAY

LCD type with waterproof touch pad

#### • External Dimensions

5.85 in. x 4.12 in.

148.1 mm. x 104.7 mm.

#### • Active Area

4.53 in. x 3.40 in.

115.1 mm. x 86.3 mm.

For more information about the products we offer,  
contact us at [sales@belmontmedtech.com](mailto:sales@belmontmedtech.com).



PATIENT  
WARMING



PATIENT  
COOLING



FLUID  
MANAGEMENT



780 BOSTON ROAD  
BILLERICA, MA 01821, USA

USA: 866.663.0212

WORLDWIDE: +1 978.663.0212

FAX: 978.663.0214

[WWW.BELMONTMEDTECH.COM](http://WWW.BELMONTMEDTECH.COM)



The Belmont® Rapid Infuser RI-2 has been evaluated with respect to electrical shock, fire and mechanical hazards in accordance with applicable standards.

Belmont Instrument LLC  
Registered to ISO 13485  
File Number: A18173

Belmont Medical Technologies™ is a trademark of Belmont Instrument, LLC  
2019 © Belmont Instrument, LLC | 701-00136 Rev. H